

Westside Clinic 5mi/8km

# PORTLAND & OREGON



Salt and Straw

NW Glisan St

NW Everett St

W. Burnside

Rose Garden

Japanese Garden

Zoo

Hotel deLuxe

Heart Coffee

Palace Cakes

Portland Art Museum

Whole Foods

Powell's Books

Food Carts

Tasty n Alder

Target

Pioneer Square

Kure Juice Bar

Bowery Bagels

Lan Su Chinese Garden

Voodoo Doughnut

SW Ankeny St

SW Washington St

SW Alder St

SW Morrison St

SW Yamhill St

SW Main St

SW Madison St

NW Lovejoy

NW 21st Ave

NW 23rd Ave



NW 11th  
NW 10th

NW Broadway

NW Glisan St

NW Everett St

W. Burnside

SW Washington St

SW Alder St

SW Morrison St

SW Yamhill St

SW Main St

SW Madison St

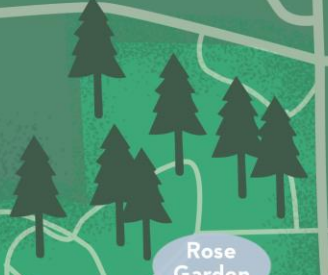

**BRUNCH + LUNCH :**

- [Gracie's](#) @ Hotel DeLuxe | 729 SW 15<sup>th</sup> Ave | 503.222.2171 | \$\$\$
- [Tasty N Alder](#) | 580 SW 12th Ave | 503.621.9251 | \$\$
- [Lardo](#) | 1205 SW Washington St | 503.241.2490 | \$\$
- [Cheryl's on 12<sup>th</sup>](#) | 1135 SW Washington St | 503.595.2252 | \$\$
- [Addy's Sandwich Bar](#) | 911 SW 10<sup>th</sup> Ave | 503.267.0994 | \$\$
- [Kenny & Zuke's](#) | 1038 SW Stark St. | 503.222.3354 | \$\$
- [Kinara Thai](#) | 1126 SW 18<sup>th</sup> Ave | 503.227.5161 | \$\$
- [Pastini Pastaria](#) | 911 SW Taylor St | 503.863.5188 | \$\$
- [Boxer Ramen](#) | 1025 SW Stark St | 503.894.8260 | \$\$
- [Little Big Burger](#) | 122 NW 10<sup>th</sup> Ave | 503.274.9008 | \$
- [Hot Lips Pizza](#) | 633 SW 18<sup>th</sup> Ave | 503.517.9354 | \$
- [Noodle House](#) | 590 SW Washington St | 503.998.1019 | \$
- [Brunch Box](#) | 620 SW 9<sup>th</sup> Ave | 503.477.3286 | \$
- [Dime Store](#) | 837 SW 11<sup>th</sup> Ave | 503.228.1866 | \$\$
- [Leaky Roof](#) | 1538 SW Jefferson St | 503.222.3745 | \$\$\$
- [Khao San](#) | 1435 NW Flanders St | 503.227.3700 | \$\$
- [Food Carts](#) | SW 9-- SW 10 & SW Alder St | \$--\$\$
- [Dragonwell Bistro](#) | 735 Southwest 1st Ave | 503.224.0800 | \$\$\$
- [Hot Pot City](#) | 1975 SW 1st Ave | 503.224.6696 | \$

**DINNER + AFTER :**

- [The Picnic House](#) | 723 SW Salmon St | 503.227.0705 | \$\$\$
- [Clyde Common](#) | 1014 SW Stark St | 503.228.3333 | \$\$
- [Fish Sauce](#) | 407 NW 17<sup>th</sup> Ave | 503.227.8000 | \$\$
- [Little Bird Bistro](#) | 219 SW 6<sup>th</sup> Ave | 503.688.5952 | \$\$
- [Andina](#) | 1314 NW Glisan St | 503.228.9535 | \$\$
- [Imperial](#) | 410 SW Broadway St | 503.228.7222 | \$\$\$
- [Ristorante Roma](#) | 622 SW 12<sup>th</sup> Ave | 503.241.2692 | \$\$
- [Grassa](#) | 1205 SW Washington St | 503.241.1133 | \$
- [Gruner](#) | 527 SW 12<sup>th</sup> Ave | 503.241.7163 | \$\$
- [Jake's Grill](#) | 611 SW 10<sup>th</sup> Ave | 503.220.1850 | \$\$
- [Habibi Restaurant](#) | 1012 SW Morrison St | 503.274.0628 | \$
- [Zeus Café](#) | 303 SW 12<sup>th</sup> Ave | 503.384.2500 | \$\$
- [Southpark Seafood](#) | 901 SW Salmon St | 503.326.1300 | \$\$\$
- [Ringside](#) | 838 SW Park Ave | 503.227.3900 | \$\$
- [Huber's](#) | 411 SW 3rd Ave | 503.228.5686 | \$\$
- [Driftwood Room](#) @ Hotel Deluxe | 729 SW 15<sup>th</sup> Ave | \$\$\$
- [Marmo](#) | 1037 SW Morrison | 503.224.0654 | \$\$
- [Swine](#) @ Paramount Hotel | 808 SW Taylor St | 503.943.5844 | \$\$\$
- [Barlow](#) | 737 SW Salmon St | 503.227.0705 | \$\$
- [Wong's King Seafood](#) | 8733 SE Division St | 503.788.8883 | \$\$\$
- [Taste Of Sichuan](#) | 16261 NW Cornell Rd | 503.629.7001 | \$\$\$
- [Mediterranean Exploration Co.](#) | 333 NW 13<sup>th</sup> Ave | 503.222.0906 | \$\$

**JUICE, TEA + COFFEE :**

- [Kure Juice](#) | 518 SW Taylor St | 855.777.5873 | \$
- [Heart](#) | 537 SW 12<sup>th</sup> Ave | 503.224.0036 | \$\$
- [Starbucks](#) @ Sentinel Hotel | 614 SW 11<sup>th</sup> | 503.224.3400 | \$\$
- [Stumptown](#) @ Ace Hotel | 1026 SW Stark | 503.224.9060 | \$
- [Case Study Coffee](#) | 802 SW 10<sup>th</sup> Ave | 503.477.8221 | \$
- [Greenleaf Juicing](#) | 810 NW 12th Ave | 971.271.8988 | \$
- [Tao of Tea](#) @ Lan Su Chinese Garden | 239 NW Everett St | 503.228.8131 | \$\$

**BAKERY & TREATS :**

- [Palace Cakes](#) | 1401 SW Yamhill | 971.202.6845 | \$\$
- [Petunia's Pies & Pastries](#) | 610 SW 12<sup>th</sup> Ave | 503.841.5961 | \$
- [Blue Star Donuts](#) | 1237 SW Washington St | 503.265.8410 | \$
- [Coco Donuts](#) | 709 SW 17<sup>th</sup> Ave | 503.360.1456 | \$
- [Voodoo Donut](#) | 22 SW 3rd Ave | 503.241.4704 | \$
- [Bowery Bagels](#) | 310 NW Broadway | 503.227.6674 | \$
- [Ruby Jewels Ice Cream](#) | 428 SW 12th Ave | 971.271.8895 | \$
- [Salt & Straw Ice Cream](#) | 838 NW 23rd Ave | 971.271.8168 | \$

**GROCERIES :**

- [Target](#) | 939 SW Morrison St | 503.290.5361
- [Whole Foods](#) | 1210 NW Couch St | 503.525.4343 | \$\$\$
- [Fred Meyers](#) | 100 NW 20th Pl | 503.273.2004
- [Trader Joe's](#) | 2122 NW Glisan St | 971.544.0788
- [Fubon](#) | 2850 SE 82nd Ave | 503.517.8899
- [Uwajimaya](#) | 10500 SW Beaverton Hillsdale Hwy | 503.643.4512

**PLACES OF INTEREST :**

- [Lan Su Chinese Gardens](#) | 239 NW Everett St | 503.228.8131
- [Washington Park](#) | 1715 SW Skyline Blvd | 503.823.2525
- [Rose Gardens](#) | 400 SW Kingston Ave | 503.823.3636
- [Japanese Gardens](#) | 611 SW Kingston Ave | 503.223.1321
- [Portland Art Museum](#) | 1219 SW Park Ave | 503.226.2811 223.4527
- [Powell's City of Books](#) | 1005 W Burnside | 503.228.4651
- [Saturday Market](#) | 2 SW Naito Parkway | 503.241.4188
- [Portland Farmers Market](#) | SW Park Ave | 503.241.0032
- [Mission Theater & Pub](#) | 1624 NW Glisan St | 503.
- [Pioneer Courthouse Square](#) | 701 SW 6th Ave | 503.223.1613
- [Pioneer Square Center](#) | 700 SW 5<sup>th</sup> Ave | 503.228.5800
- [Waterfront Park](#) | SW Naito Pkwy | 503.823.7529
- [Portland Aerial Tram](#) | 3303 SW Bond Ave | 503.494.8283
- [Portland's Center for the Arts](#) | 1111 SW Broadway | 503.248.4335

**SHOPPING :**

Please ask us, there are too many to list, and they are all Tax Free!

**ACCOMODATIONS :**

- Please ask for our full list of discounted rates for ORM families.
- [Hotel DeLuxe](#) | 729 SW 15<sup>th</sup> Ave | 503.219.2094 | \$\$\$
  - [Hotel Sentinel](#) | 614 Southwest 11th Ave | 503.224.3400 | \$\$\$
  - [Candlewood Inn](#) | 11250 NE Holman St | 503.255.4003 | \$\$
  - [Silver Cloud Inn](#) | 2426 NW Vaughn St | 503.242.2400 | \$\$

**TRANSPORTATION :**

- [TriMet](#) | TriMet.org | 503.238.7433
- [Car2Go](#) | Car2Go.com/EN/Portland | 877.488.4224
- [Zipcar](#) | ZipCar.com/Portland | 503.328.3539
- [Uber](#) | Uber.com/Cities/Portland
- [Broadway Cab](#) | 503.333.3333
- [Radio Cab](#) | 503.227.1212

Notes: .....

.....

.....

.....

.....

.....

.....

.....

.....

These are some of our recommended places in Portland & the surrounding areas. Enjoy!  
Any questions, please feel free to outreach:  
[hello@oregonreproductivemedicine.com](mailto:hello@oregonreproductivemedicine.com)

